

Date	Rev. date	Work nr.	Drw. nr.	Rev.
Drawn by Ruukki	Rev.	M30/S03	-	
Scale 1:3	Building		File nr. P2001/003-00040	

Hidden fixing requires to use
EA1B61CN15015.
In case of fixing sandwich panel with two
fasteners distance between them should
be at least 50 mm.
Quantity of fastners should be
calucaulated by using program TrayPan.

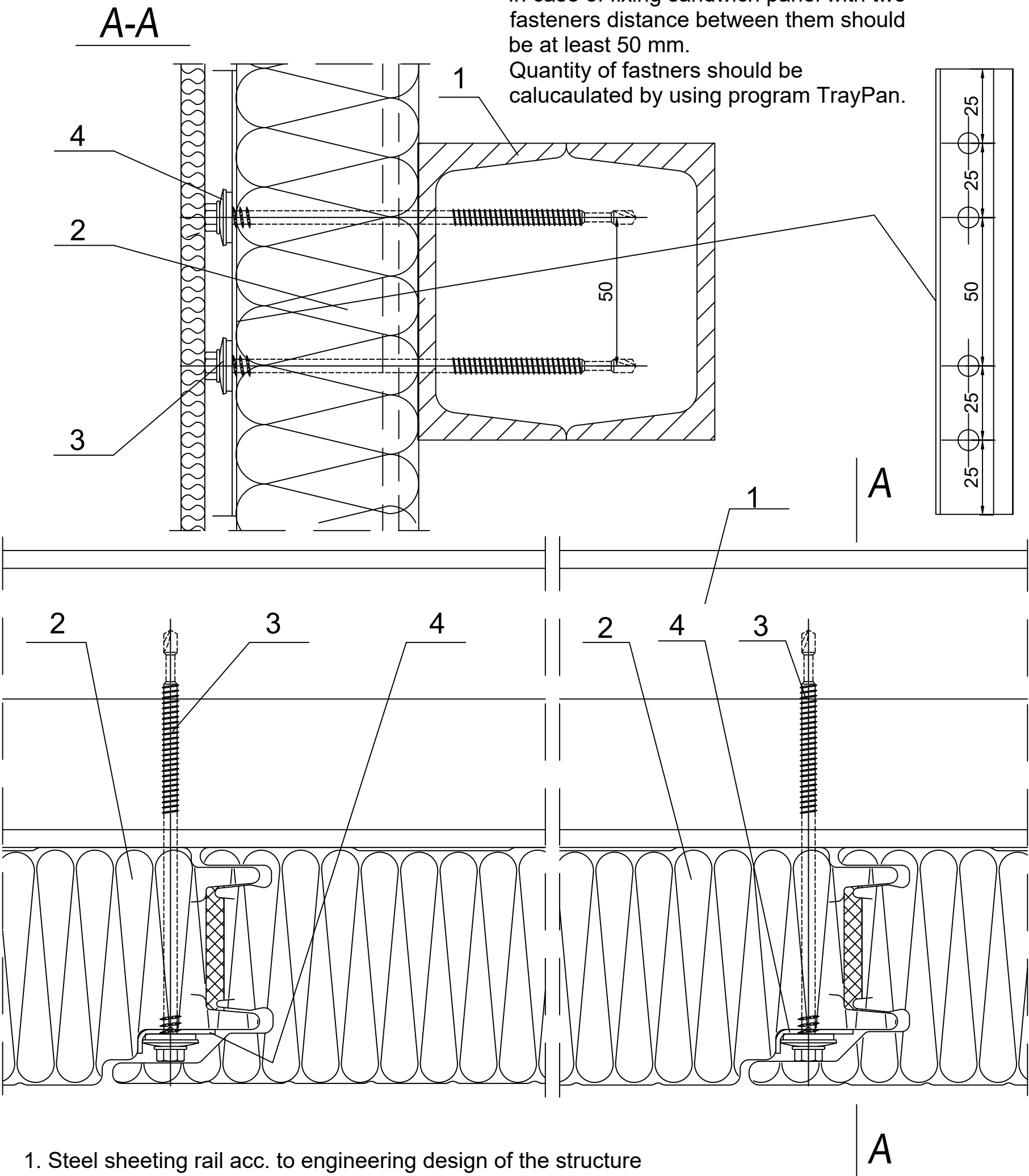

- 1. Steel sheeting rail acc. to engineering design of the structure
- 2. Ruukki SP2D PIR
- 3. Panel fastener for hot-rolled sheeting railor for cold-bent sheeting rail
- 4. EA1B61CN15015 fastener